

VARIUSmed

Multiple washbasins for medical facilities



CUSTOMIZED ERGONOMICS AND HYGIENE

- The seamless VARIUSmed multiple washbasins are specially designed for use in OR washrooms.
- Their variable number of basins (1 to 3) and dimensionally accurate production provide washroom facilities customized to the respective building.
- Ergonomically shaped large bowls, with a reduced extension in the faucet area, provide comfortable conditions to doctors and hospital staff for conveniently washing and disinfecting hands and arms.
- The geometry of the washbasins, with a slight slant towards the wall, prevents water dripping.
- The resin bonded mineral material is completely enclosed by a pore-free, smooth outer skin.
- The Alpine white Gelcoat coating is resistant to chemical and physical stresses, such as the use of disinfectants, and has excellent cleaning properties.
- Special repair sets make it easy to repair surface damage.



VARIUSmed multiple washbasins are completely coated with Gelcoat. The hygienically smooth surface effectively counteracts the adhesion of bacteria and micro-organisms.

*Make
it
Wonderful*

FRANKE

VARIUSmed multiple washbasin

made of MIRANIT resin-bonded mineral material, with a non-porous smooth surface (temperature resistant up to 80°C) coated all around. Alpine white colour.

With up to 3 seamlessly integrated bowls, without overflow. Variable bowl distance, centre distance of bowls at least 700 mm. Ergonomic bowl shape with large inside radii, with slight rearward slant to prevent dripping water.

Integral back panel with integrated brackets and holes for fixing. Rear contoured edge. Including fastening materials.

Dimensions (W x H x D): 700 - 3200 x 230 x 550 mm

Bowl dimensions (W x H x D): 645 x 205 x 440 mm

Washbasin thickness: 25 mm

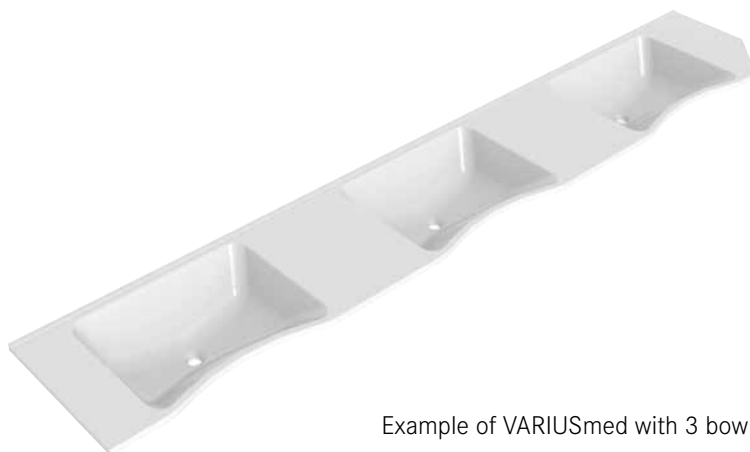

Example of VARIUSmed with 3 bowls

Customized fit to building specifications

Detailed specifications such as installation type and basin spacing, etc. are detailed on planning sheets for each specific project (to be requested from Franke).

Optional accessories

TYPE	ARTICLE NUMBER
Strainer waste valve G 1 1/4 B	
Z-ANMW901	2000100854
WASH-S electronic wash fitting for wall mounting with swivel spout, extension 266 mm	
PRTR0017	2030015990

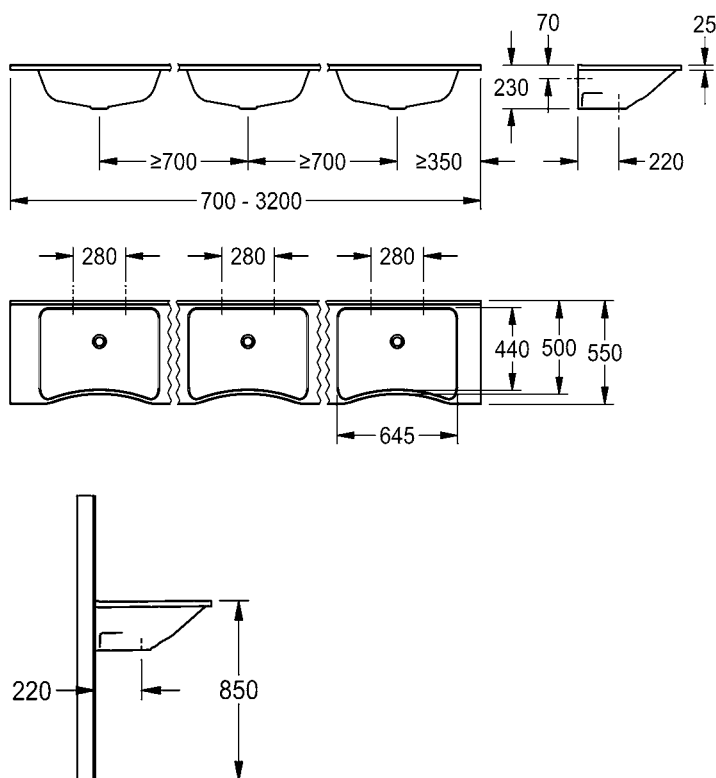

Franke Water Systems



Status 06.2015